

# HIGH TORQUE CLINCH STUDS- IHPFH

## NOTES

Maximum hardness of parent material: Steel parts - 85 HRB, Stainless Steel parts - 70 HRB. Please note that Stainless Steel parts cannot usually be successfully installed into Stainless Steel Sheet.



## IHPFH

THREAD AND PITCH	H Max	Min Sheet Thickness	Hole Size +0.13 -0.0	S Max	D +/- 0.25	Min C/L to edge of panel	Torque Out (Nm)	Push Out (N)
M5 x 0.8	2,7	1,3	5,0	1,14	7,8	10,7	7,8	1496
M6 x 1.0	2,8	1,5	6,0	1,27	9,4	11,5	16,1	2036
M8 x 1.25	3,5	2,0	8,0	1,78	12,5	12,7	37,3	2787
M10 x 1.5	4,1	2,3	10,0	2,29	15,7	13,7	47,9	4103

Torque out & Push out figures are to be used as a guide only and will vary depending on panel thickness and installation method. Figures are based on installation into 1.5mm cold rolled steel for M5 & M6, and 2.3 mm cold rolled steel for M8 & m10 under test conditions.

## STANDARD LENGTHS

Thread Size	Length +/- 0.4									
	15	20	25	30	35	40	45	50		
M5	15	20	25	30	35	40	45	50		
M6	15	20	25	30	35	40	45	50		
M8	15	20	25	30	35	40	45	50		
M10	15	20	25	30	35	40	45	50		
M5	8	10	12	15	18	20	25	30	35	

HIGH TORQUE CLINCH STUDS – IHPFH

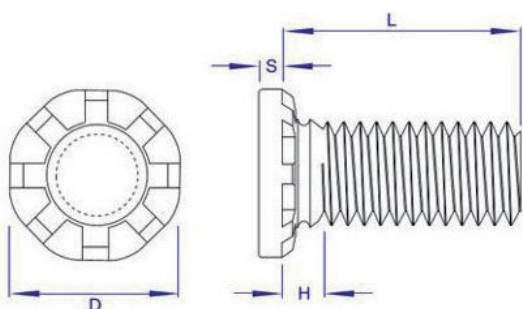

## MATERIALS AND OTHER TYPES

- Carbon Steel
- 300 series Stainless Steel
- Zinc
- Plain