

MINIATURE ROUND RIVET BUSH KNURLED SPIGOT - IMINARB

NOTES

Miniature Round rivet bushes provide strong reusable threads in panels too thin to be conventionally tapped. They can be installed into panels as thin as 0.5mm and do not suffer from the maximum hardness limitations of self-clinching nuts and standoffs so they are suitable for installation into stainless steel panels. The round knurled spigot patterns provides excellent resistance to torque in softer materials and are available in steel and stainless steel as standard with aluminum and brass available to order.



IMINARB

THREAD AND PITCH	Sheet Metal Thickness	Hole Size +0.1/-0.0	D + - 0.13	H + - 0.13	C + 0.0/- 0.13
M2.5 x 0.45	001-016	4,3	5,5	2,8	4,2
M3 x 0.5	001-016	4,3	5,5	2,8	4,2
M3,5 x 0.6	001-016	5,5	7	3,2	5,4
M4 x 0.7	001-016	5,5	7	3,2	5,4
M5 x 0,8	001-016	6,5	8,5	3,8	6,4
M6 x 1.0	001-016	7,7	10	5,1	7,6
M8 x 1.25	001-016	9,8	12	6,5	9,7

GAUGE CONVERSION CHART

Shank Code	001	003	004	006	008	010	012	013	014	016
Sheet Metal Thickness	0,5	0,7	0,9	1,1	1,4	1,7	2,0	2,3	2,6	2,9
	0,6	0,8	1,0	1,3	1,6	1,9	2,2	2,5	2,8	3,1

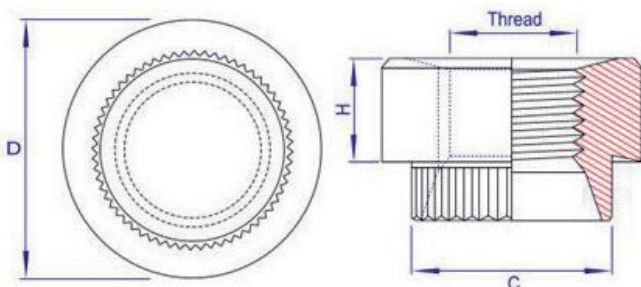

MATERIAL AND PLATING

- Mild Steel
- 300 series Stainless Steel
- Aluminum and Brass to special order
- Zinc
- Plain