

# THROUGH HOLE STANDOFF - IPTSO

## NOTES

The IPTSO Through hole self-clinching standoff provides a strong torque resistant captivated female thread in a spacer configuration for thin panels' applications. This fastener installs fully flush from the back of the panel, meaning that minimal surface finishing is required after installation. Utilizing a proven clinch feature, the hexagon head provides excellent torque out and push out resistance. Like all self-clinching fasteners, they are installed using parallel squeezing action, so require access to both sides of the panel.



## IPTSO

THREAD AND PITCH	Sheet thickness	Hole Size +0.08/-0.0	C +0.0 -0.13	D	E Nom	Min C/L to edge	Torque out Nm	Push Out Nm
M2.5 / M3 *	1,0	4,20	4,18	3,20	4,80	6,0	2,63	1012
5.4 M3	1,0	5,40	5,39	4,00	6,40	6,8	4,10	1879
M4	1,3	7,20	7,14	4,80	7,90	8,0	8,48	2517
M5	1,3	7,20	7,14	5,20	7,90	8,0	8,48	2517

## LENGTHS

Thread	Length											
	4	5	6	8	10	12	14	16	18	20		
M2.5 / M3 *	4	5	6	8	10	12	14	16	18	20		
5.4 M3	4	5	6	8	10	12	14	16	18	20		
M4			6	8	10	12	14	16	18	20		
M5			6	8	10	12	14	16	18	20	22	
Trou non fileté	-			4			8		10	12		

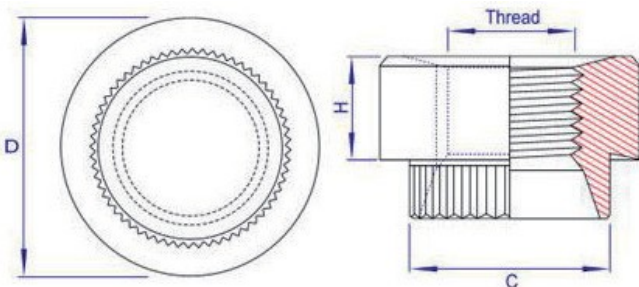

## MATERIAL AND PLATING

- Carbon Steel
- 300 Series Stainless Steel
- 400 Series Stainless Steel
- Aluminum and Brass to special order
- Zinc
- Plain